

CAPE GEORGE COLONY CLUB
 61 CAPE GEORGE DRIVE
 PORT TOWNSEND, WA 98368

RECEIVED MAY 31 2017

PHONE: (360) 385-1177
 FAX: (360) 385-3038

CGCC BUILDING PERMIT APPLICATION

Name: <u>GEORGE H. CONNER</u>		Date: <u>5-26-17</u>
Property Address: <u>30 MAXWELL AVE</u>		Port Townsend, WA 98368
Email Address: <u>GHCANNER67@HOTMAIL.COM</u>	Daytime Phone: <u>206-898-6578</u> Evening Phone: <u>253-838-0117</u>	
Request Building Permit for: Select one	Legal Location: <u>MARCEL NO. 965005D3</u>	
Home <input checked="" type="checkbox"/> Outbuilding <input type="checkbox"/>	Blk No. _____	Colony <input type="checkbox"/>
Manufactured/Mobile Home <input type="checkbox"/> Other <input type="checkbox"/>	Div No.: _____	Village <input type="checkbox"/>
Addition <input type="checkbox"/>	Lot No.: _____	Highlands <input checked="" type="checkbox"/>

Please answer the following questions		YES	NO
1	I agree to abide by the CGCC Building and Property Regulations?	<input checked="" type="checkbox"/>	<input type="checkbox"/>
2	Can the location of your proposed building be determined by survey markers?	<input checked="" type="checkbox"/>	<input type="checkbox"/>
3	Have your plot plans been prepared according to the CGCC Building and Property Regulations?	<input checked="" type="checkbox"/>	<input type="checkbox"/>
4	Do the plans show the location of underground utilities?	<input checked="" type="checkbox"/>	<input type="checkbox"/>
5	Do your plans require a Variance Request?	<input checked="" type="checkbox"/>	<input type="checkbox"/>
6	Manufactured/Mobile Home Installation: (a) Does the plot plan include a description of the manufactured/mobile home year and the dimensions, not including the tongue? (b) Does the concrete slab floor on which the manufactured/mobile home is to be installed have a minimum thickness of three and one-half (3 1/2) inches?	<input type="checkbox"/>	<input checked="" type="checkbox"/>
7	Indicate the exact set-back as measured from the front property line to the nearest point of structure, including overhangs (minimum set back requirement is 25 feet): <u>SEE SITE PLAN</u>	<u>48</u> ft. <u>0</u> in.	
8	Indicate the exact overall height of structure as measured from point of highest natural grade at the foundation line to highest point of roof ridge (maximum height of 17 feet): <u>HEIGHT VARIES</u>	<u> </u> ft. <u> </u> in.	
9	Indicate the exact square footage of your living area – minimum 1,000 sq.ft.	<u>1636</u> sq ft	
Attach a copy of Approved Jefferson County permit and plans.		<input checked="" type="checkbox"/> attached	
Attach plot plans per CGCC Building and Property Regulations.		<input checked="" type="checkbox"/> attached	
Attach Fills/Earthwork/Culverts/Drainage Permit application, if applicable		<input checked="" type="checkbox"/> attached	
Attach driveway Connection Permit application.		<input checked="" type="checkbox"/> attached	
Attach Water Connection Permit application, if applicable		<input checked="" type="checkbox"/> attached	
Attach Variance Request application, if applicable		<input checked="" type="checkbox"/> attached	

Contact Building Committee upon completion of your project for final

Owner's or Agent's signature: <u>George H. Conner</u>	Date: <u>5-26-17</u>
---	----------------------

Building Committee: <input checked="" type="checkbox"/> Approved <input type="checkbox"/> Disapproved (reason):	Date:
Signature: <u>W.F. [Signature]</u>	<u>6/20/2017</u>
Manager Signature: <u>[Signature]</u>	Date: <u>6/20/17</u>



SCALE
1" = 20'-0"

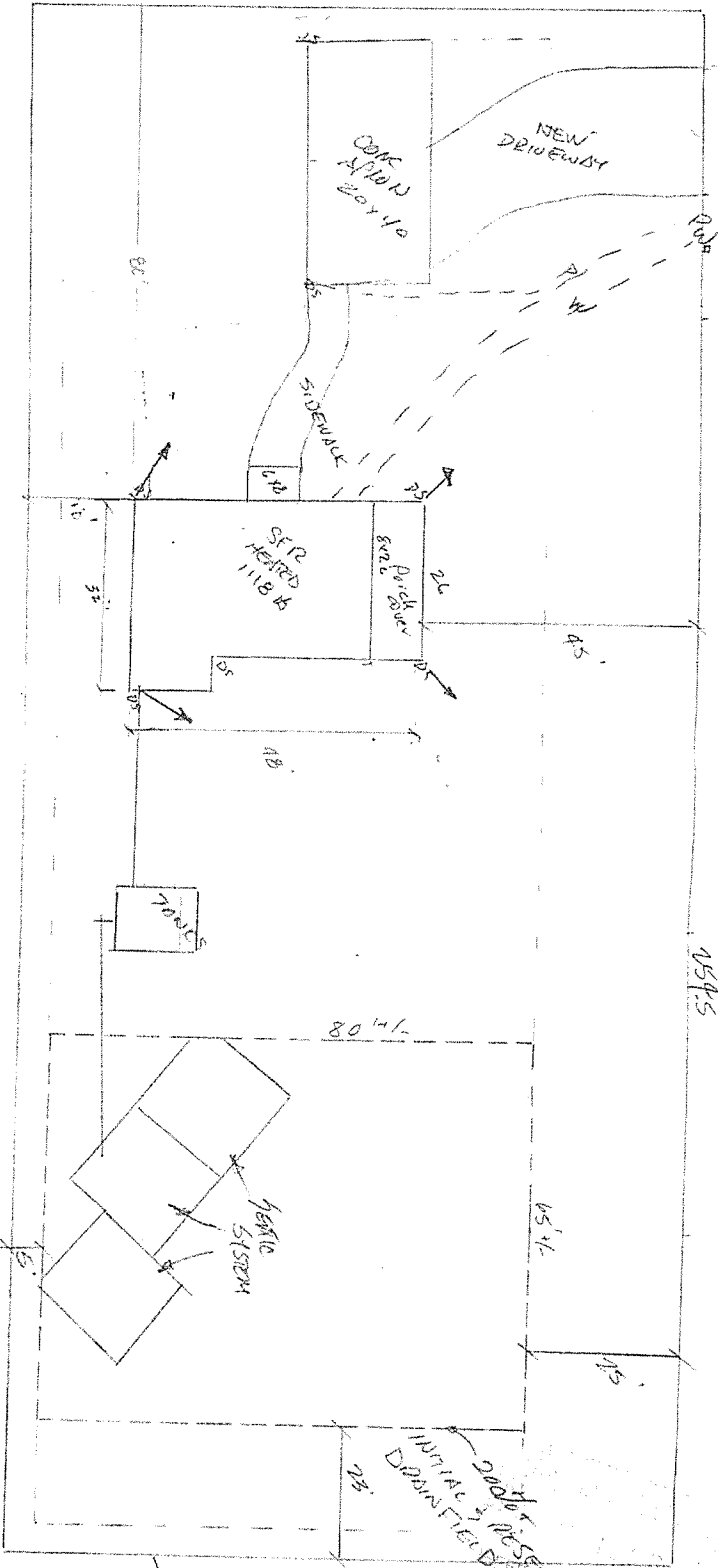

0" AVE
JAC

MAXWELL AVE

R. SW

George Conner
#961500503
30 MAXWELL

IMPERVIOUS SURFACE
HOME 1636

SIDEWALKS
DRIVEWAY
OTHER

200
200
800

2836

SITE 30,600 A
10%

LOTS 4-8

APPROVED
SITE PLAN
JEFFERSON COUNTY
DEPT. OF COMMUNITY DEVELOPMENT
MAY 22 2017
SIGNATURE: [Signature]

APPROX
PROPERTY
LINES

2000' RESERVATION
INITIAL 5' RESERVATION